



---

**HINGED DOOR** | LOCKS & ACCESSORIES

## DS1400 | HINGED DOOR FURNITURE

Doric's DS1400 Series hinged door furniture is cast from aluminium and finished in either black or white powder coat. Suitable for use in residential applications.

This unsprung handle is easy to assemble and has been the industry standard for over 20 years. Once the escutcheon plates are fitted, the lever is attached to the spindle and secured by a M5 grub screw.

The DS1400 has a 85mm pitch between lever spindle and the keyed cylinder barrel and is suitable for Doric Swing Bolt Euro cylinder mortice locks listed below.

The DS1400 furniture is kitted with Doric DS1265, DS1289 and DS1295 mortice lock packs.

### ADVANTAGES

- Lever and Escutcheon manufactured from cast aluminium
- Durable powder coat finish
- Suitable for hinged doors in single french and bi-folding application
- Easy installation
- Universal standard 85mm pitch between lever spindle & cylinder barrel
- Lever can be rotated for left or right handing

### PRODUCT DETAILS

MATERIAL	Aluminium
FINISH	Powder coat & Satin Chrome Plated
SUITABILITY	Hinged doors in french or bi-folding application

### HOW TO ORDER

FURNITURE	LOCKBODY	FINISH	CYLINDER	KEYING	STRIKE
DS1400/0 DS1400/5	DS1265 DS1289 DS1295	Powder Coat Black Satin Chrome	DS1272 DS1266 DS197 DS202	96001	DS1277/S DS1277/M DS1277/L



**DS1400/0 Hunter**



**DS1400/5 Swan**

# DIMENSIONS

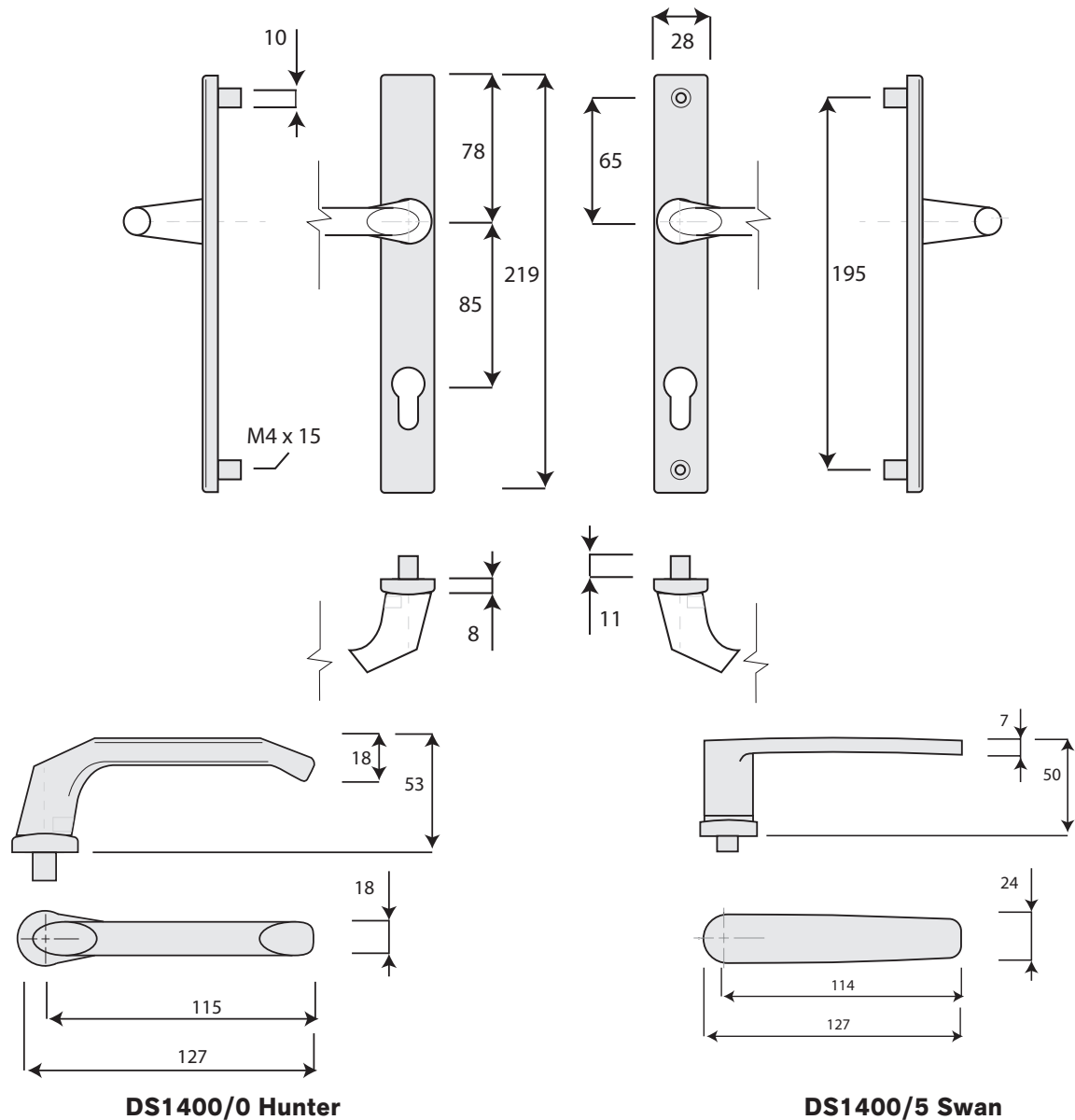

## MORTICE LOCK BODY OPTIONS



**DS1265**  
SINGLE POINT  
SWING BOLT  
MORTICE  
LOCKBODY



**DS1289**  
MULTI POINT  
LONG THROW  
SWING BOLT  
MORTICE  
LOCKBODY



**DS1295**  
SINGLE POINT  
PROJECTION BOLT  
MORTICE  
LOCKBODY

## DS1500 | HINGED DOOR FURNITURE

Doric's DS1500 series hinged door furniture is suitable for residential & commercial entrance door applications. Finished in Satin Stainless steel, both the lever and escutcheon cover are manufactured from marine grade 316 Stainless steel.

The high pressure cast zinc escutcheon chassis houses the high performance spring mechanism. Each handle consists of a Quad sprung, Twin shuttle, Cam action spring mechanism to return the levers to its horizontal position time after time.

The DS1500 is suitable for Euro Cylinder mortice locks with 85mm pitch between lever spindle and the keyed cylinder barrel.

The DS1500 furniture is kitted with Doric's DS1265, DS1289 and DS1295 mortice lock packs.

### ADVANTAGES

- Lever and Escutcheon cover manufactured from marine grade 316 Stainless steel
- Quad sprung, Twin shuttle, Cam action spring mechanism
- Universal standard 85mm pitch between lever spindle & cylinder barrel

### PRODUCT DETAILS

MATERIAL	316 Stainless steel
FINISH	Satin Stainless steel
SUITABILITY	Hinged doors in french or bi-folding application

### HOW TO ORDER

FURNITURE	LOCKBODY	FINISH	CYLINDER	KEYING	STRIKE
DS1500/3 DS1500/5 DS1500/6	DS1265 DS1289 DS1295	Stainless steel	DS1272 DS1266 DS197 DS202	96001	DS1277/S DS1277/M DS1277/L



**DS1500/3 Manly**



**DS1500/5 Swan**



**DS1500/6 Tumut**

# DIMENSIONS

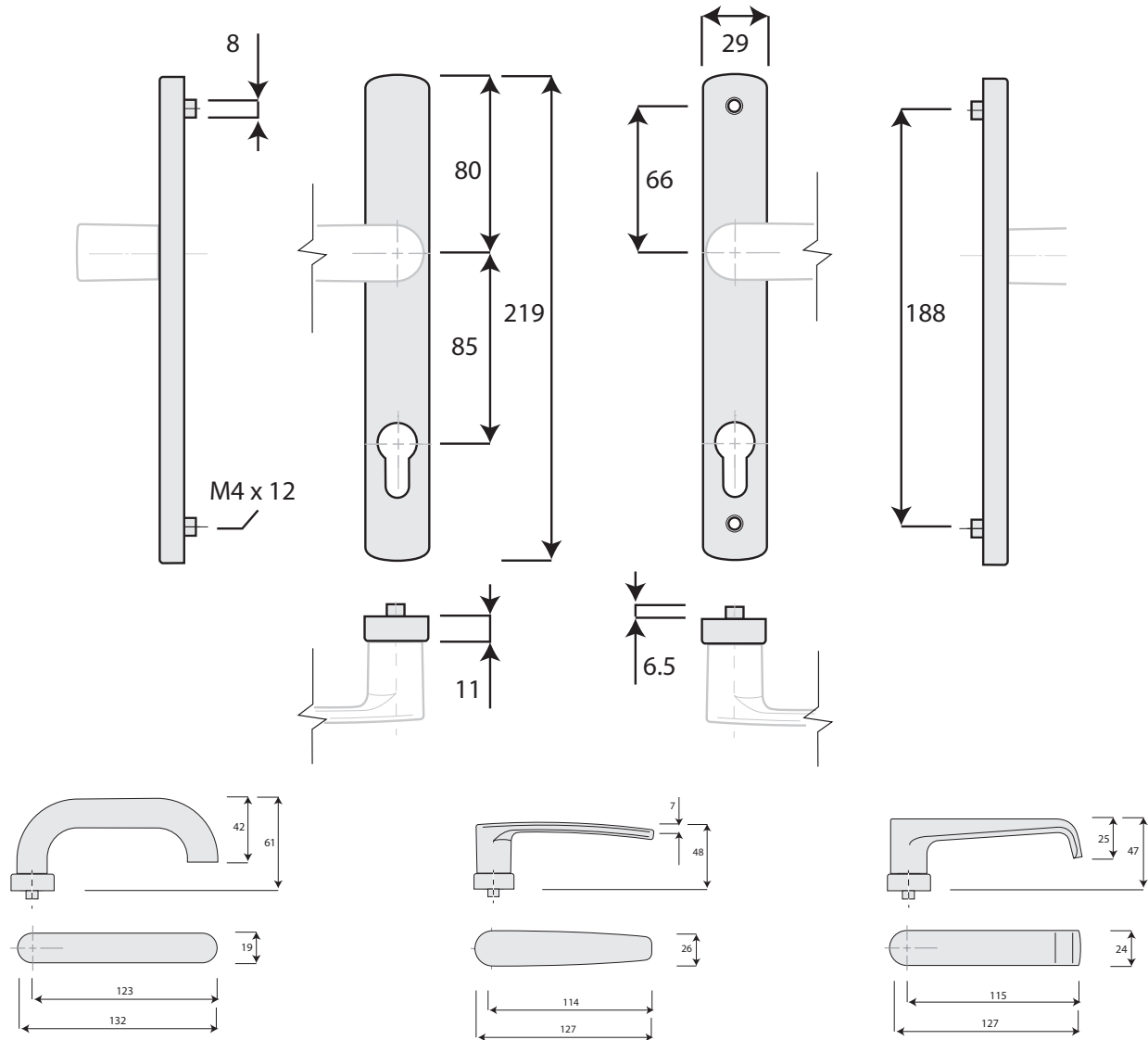

**DS1500/3 Manly**

**DS1500/5 Swan**

**DS1500/6 Tumut**

# MORTICE LOCK BODY OPTIONS

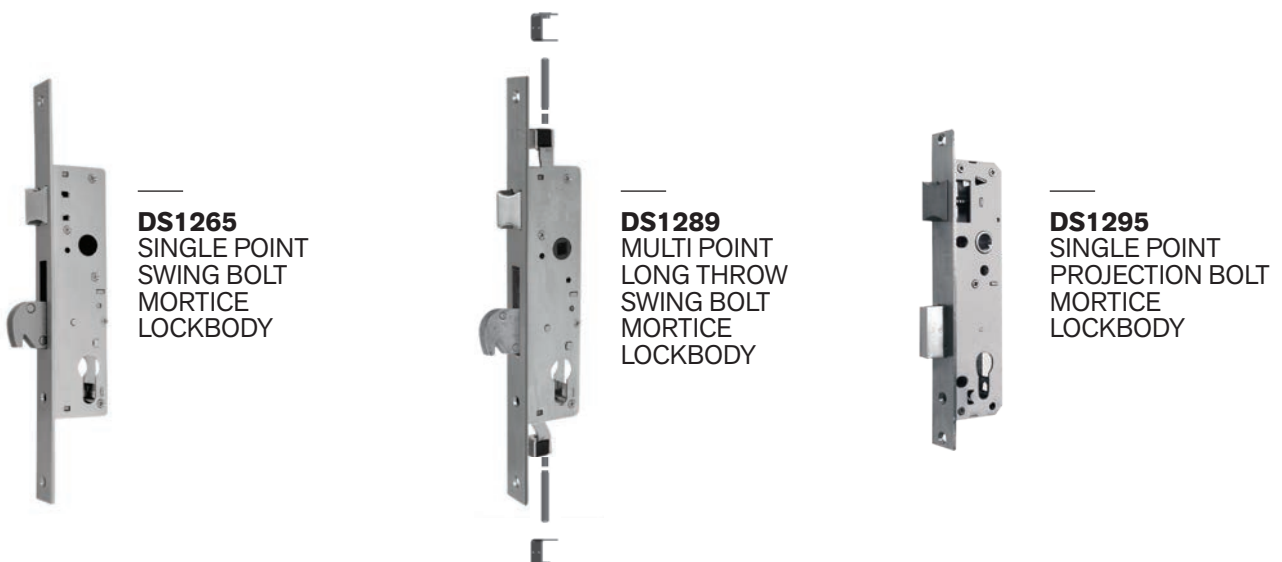

# DS1600 | HINGED DOOR FURNITURE

Doric's DS1600 Series hinged door furniture is suitable for use in residential applications and is available in a wide range of durable powder coat colors with 17 degree lever shaft layback.

This lockset increases the clearance between the lever and the door frame, advantageous when opening with a narrow backset mortice lock.

Levers and escutcheon plates are manufactured from high pressure cast zinc, enhancing both strength and durability. Each handle consists of a Parallel leaf spring assembly to return the levers to the horizontal position.

Suitable for Euro Cylinder mortice locks with 85mm pitch between lever spindle and the keyed cylinder barrel.

The DS1600 furniture is kitted with Doric DS1265, DS1289 and DS1295 mortice lock packs.

## ADVANTAGES

- Lever and Escutcheon manufactured from high pressure cast zinc
- Parallel Leaf Spring Assembly spring mechanism
- 17 degree lever shaft layback for greater clearance during opening
- Universal standard 85mm pitch between lever spindle and cylinder barrel
- Non handed mechanism allows for easy selection on site for left or right hand doors

## PRODUCT DETAILS

MATERIAL	High pressure cast zinc
FINISH	Powder coat or Satin Chrome
SUITABILITY	Hinged door in french or bi-folding application

## HOW TO ORDER

FURNITURE	LOCKBODY	FINISH	CYLINDER	KEYING	STRIKE
DS1600/5 DS1600/6	DS1265 DS1289 DS1295	PC Black PC White Satin Chrome	DS1272 DS1266 DS197 DS202	96001	DS1277/S DS1277/M DS1277/L



**DS1600/5 Swan**



**DS1600/6 Tumut**

**Notes:**

*DS1600/5 Swan also has an internal cylinder only version which is the DS1605/5*

# DIMENSIONS

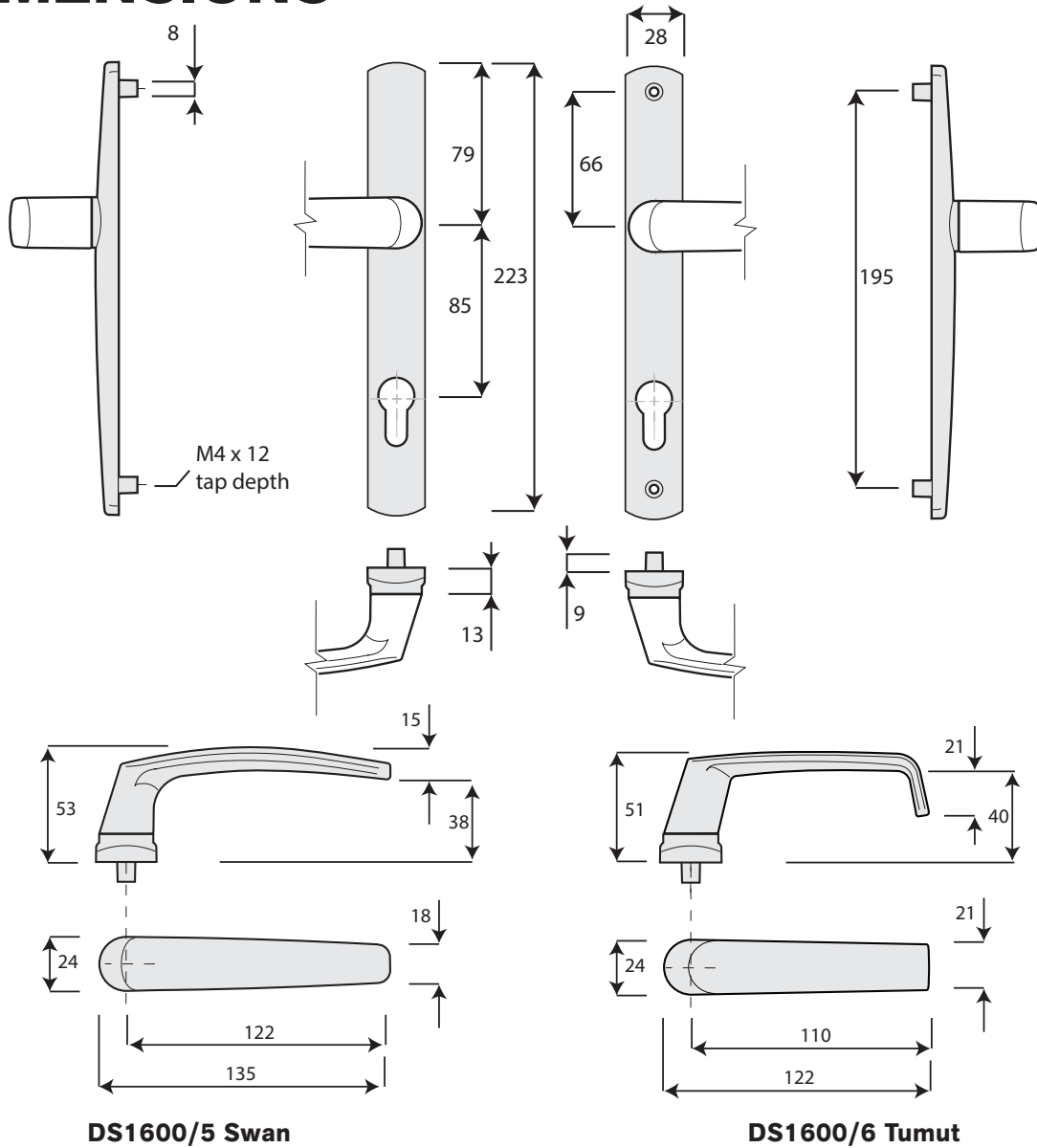

**DS1600/5 Swan**

**DS1600/6 Tumut**

## MORTICE LOCK BODY OPTIONS



**DS1265**  
SINGLE POINT  
SWING BOLT  
MORTICE  
LOCKBODY



**DS1289**  
MULTI POINT  
LONG THROW  
SWING BOLT  
MORTICE  
LOCKBODY



**DS1295**  
SINGLE POINT  
PROJECTION BOLT  
MORTICE  
LOCKBODY

**HINGED DOOR | BOLT MORTICE LOCKBODYS**

# **DORIC'S STRONG AND SECURE MOTRICE LOCKBODY RANGE**



**DS1265** | SINGLE POINT  
SWING BOLT  
MORTICE LOCKBODY



**DS1289** | MULTI POINT  
LONG THROW SWING BOLT  
MORTICE LOCKBODY



**DS1295** | SINGLE POINT  
PROJECTION BOLT  
MORTICE LOCKBODY

# DS1265 | SINGLE POINT SWING BOLT MORTICE LOCKBODY

## FUNCTION

The DS1265 latch hub retracts the latch bolt (via a spindle fitted to the furniture/handles). Key throws and retracts the swing bolt (via fixed cam euro cylinder). Key also retracts the latch.

## PRODUCT DETAILS

APPLICATION	Aluminium & Timber
BACKSET	30mm
BOLTS	Latchbolt - 10mm throw, chrome plate brass reversible latch  Deadbolt - 26mm throw, steel laminated long throw swing bolt
FACE PLATE FINISHES	Stainless steel
CYLINDER	<b>Standard:</b> DS1272 Euro Cylinder - 5 pin C4 with fixed drive cam  <b>Optional:</b> DS1266 Euro Cylinder - 5 pin C4 with fixed drive cam and inside turn  DS197 Euro Cylinder - 5 pin C4 with fixed drive  DS202 Euro Cylinder with fixed drive cam and inside turn
STRIKE PLATES	<b>Standard:</b> DS1277 <b>Optional:</b> Small, Medium and Long Lip Strikes

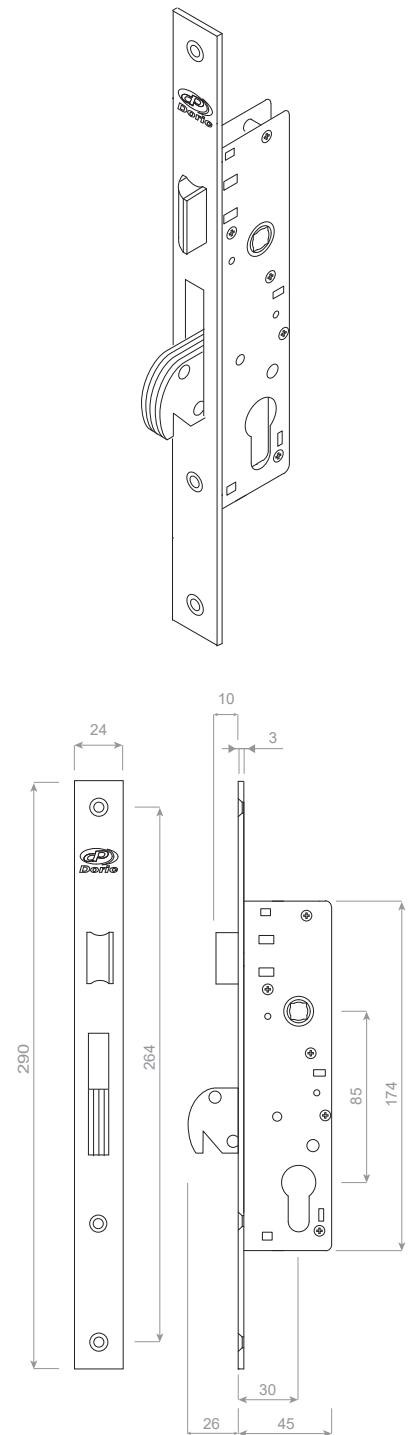

## HOW TO ORDER

LOCKBODY	FURNITURE	FINISH	CYLINDER	KEYING	STRIKE
DS1265	DS1400/0 DS1400/5 DS1500/3 DS1500/5 DS1500/6 DS1600/5 DS1600/6	Silver	DS1272 DS1266 DS197 DS202	96001	DS1277/S DS1277/M DS1277/L

# DS1289 | MULTI POINT LONG THROW SWING BOLT MORTICE LOCK

## FUNCTION

DS1289 latch hub retracts the latch bolt (via spindle fitted to the furniture/handles) and the key throws & retracts the swing bolt & vertical shoot bolt actuators (via Fixed Cam Euro Cylinder). Key can also retract latch.

## PRODUCT DETAILS

APPLICATION	Aluminium & Timber
BACKSET	30mm
BOLTS	Latchbolt - 12mm throw, reversible brass bolt, chrome plated  Deadbolt - 26mm throw, steel chrome plated with hardened steel middle plate
FACE PLATE FINISHES	Satin Stainless steel
CYLINDER	<b>Standard:</b> DS1272 Euro cylinder - 5 pin C4 with fixed drive cam  <b>Optional:</b> DS1266 Euro cylinder - 5 pin C4 with fixed drive cam and inside turn  DS197 Euro cylinder - 5 pin C4 with fixed drive cam  DS202 Euro Cylinder - 5 pin C4 with fixed drive cam and inside turn
STRIKE PLATES	<b>Standard:</b> DS1277 <b>Optional:</b> Small, Medium and Long Lip strikes

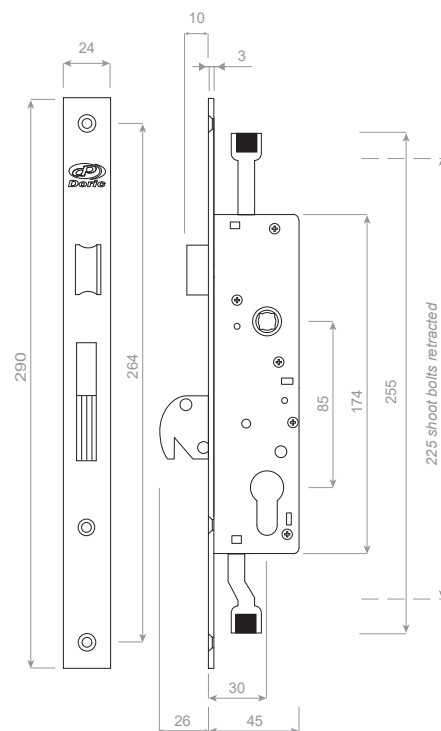
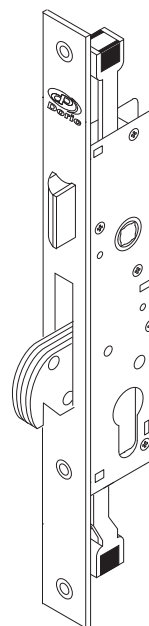

## HOW TO ORDER

LOCKBODY	FURNITURE	FINISH	CYLINDER	KEYING	STRIKE
DS1289	DS1400/0 DS1400/5 DS1500/3 DS1500/5 DS1500/6 DS1600/5 DS1600/6	Silver	DS1272 DS1266 DS197 DS202	96001	DS1277/S DS1277/M DS1277/L

# DS1295 | SINGLE POINT PROJECTION BOLT MORTICE LOCKBODY

## FUNCTION

The DS1295 latch hub retracts the latch bolt (via a spindle fitted to the furniture/handles). Key throws and retracts the swing bolt (via fixed cam euro cylinder). Key also retracts the latch.

## PRODUCT DETAILS

APPLICATION	Aluminium & Timber
BACKSET	25mm & 30mm
BOLTS	Latchbolt - 13mm throw, zinc chrome plated Deadbolt - 16mm, zinc chrome plated
FACE PLATE FINISHES	Satin Stainless steel
CYLINDER	<b>Standard:</b> DS1272 Euro cylinder - 5 pin C4 with fixed drive cam  <b>Optional:</b> DS1266 Euro cylinder - 5 pin C4 with fixed drive cam and inside turn  DS197 Euro cylinder - 5 pin C4 with fixed drive cam  DS202 Euro Cylinder - 5 pin C4 with fixed drive cam and inside turn
STRIKE PLATES	<b>Standard:</b> DS1277 <b>Optional:</b> Small, Medium and Long Lip strikes

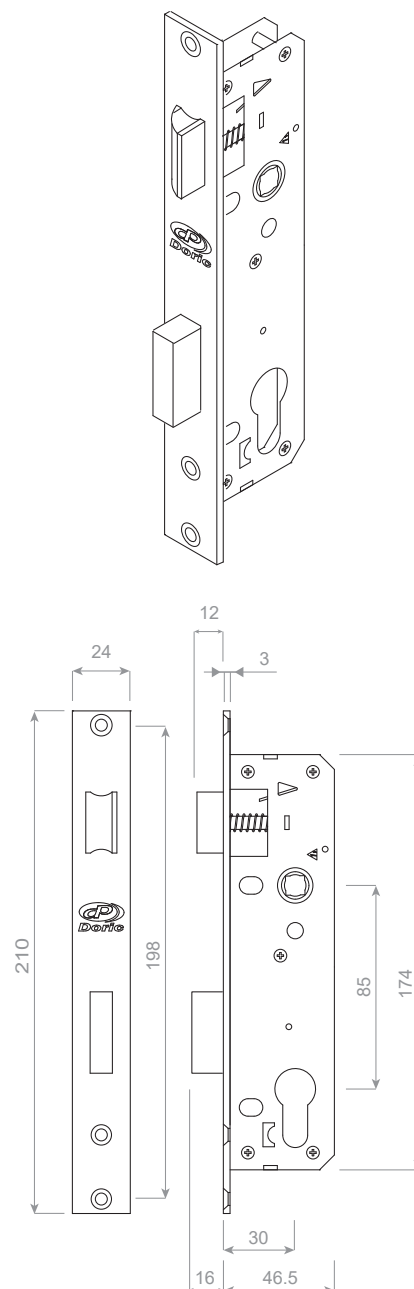

## HOW TO ORDER

LOCKBODY	FURNITURE	FINISH	CYLINDER	KEYING	STRIKE
DS1295	DS1400/0 DS1400/5 DS1500/3 DS1500/5 DS1500/6 DS1600/5 DS1600/6	Silver	DS1272 DS1266 DS197 DS202	96001	DS1277/S DS1277/M DS1277/L

# INNOVATORS

OF HARDWARE FOR WINDOWS AND DOORS

---

HINGED\_DOOR\_LOCKS\_DAP.v1.1-11.05.2020

## SYDNEY

38 Redfern St,  
Wetherill Park  
Sydney, NSW 2164  
Australia  
Ph: +61 2 9609 2555  
[www.doric.com.au](http://www.doric.com.au)

## AUCKLAND

26/C Triton Drive,  
Albany, North Shore,  
New Zealand 0632  
Auckland  
Ph: +64 9 415 5535  
[www.doricnz.co.nz](http://www.doricnz.co.nz)

## KUALA LUMPUR

No.17 Jalan 51/203A,  
Kawasan Perindustrian Tiong Nam,  
Seksyen 51, 46050 Petaling Jaya,  
Selangor, Malaysia  
Ph: +603 777 33 628  
[www.doric.com.my](http://www.doric.com.my)



**ALCHIN  
LONG  
GROUP**



---

# HINGED DOOR | LOCKS & ACCESSORIES